

Nordfab

Slotted Hoods

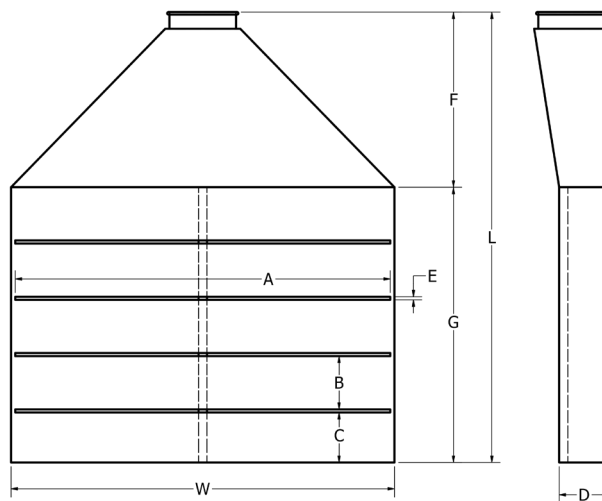

- Hoods are designed using ACGIH slotted hood principles
- When ordering, specify item number or material, gauge (if non-standard), diameter, and length.



ϕ in.	L in.	W in.	A in.	B in.	C in.	D in.	D2 in.	E in.	F in.	G in.	18ga Std Wt lbs	16ga Std Wt lbs
6	35.0	22.0	21.0	4.38	6.0	6.0	7.0	.38	10.0	25.0	28	36
7	44.0	34.0	33.0	5.38	6.0	6.0	8.0	.38	15.0	29.0	48	51
8	54.0	46.0	45.0	6.38	6.0	6.0	9.0	.38	21.0	33.0	83	89
8	63.0	58.0	57.0	7.13	6.0	6.0	9.0	.38	27.0	36.0	113	120
10	68.0	70.0	69.0	7.13	6.0	8.0	11.0	.38	32.0	36.0	n/a	165

Static pressure loss values calculated based on ACGIH compound slotted hood loss factors

ϕ in.	Velocity	CFM	Static Pressure Loss
6	2500	490	1.0
6	3000	590	1.5
6	3500	685	2.0
6	4000	785	2.7
6	4500	885	3.4
7	2500	670	0.9
7	3000	800	1.3
7	3500	935	1.7
7	4000	1070	2.2
7	4500	1205	2.8
8	2500	875	0.9
8	3000	1050	1.3
8	3500	1220	1.7
8	4000	1395	2.2
8	4500	1570	2.8
8 large	2500	875	0.7
8 large	3000	1050	1.0
8 large	3500	1220	1.4
8 large	4000	1395	1.8
8 large	4500	1570	2.3
10	2500	1365	0.9
10	3000	1635	1.3
10	3500	1910	1.7
10	4000	2180	2.3
10	4500	2455	2.9

ϕ in.	L in.	18ga Galvanized Steel Item number	16ga Galvanized Steel Item number	16ga Stainless Steel Item number
6	35.0	8010002700	8010002704	8010002709
7	44.0	8010002701	8010002705	8010002710
8	54.0	8010002702	8010002706	8010002711
8	63.0	8010002703	8010002707	8010002712
10	68.0	--	8010002708	8010002713

**Need a custom slotted hood?
Contact Nordfab to help fabricate
your custom slotted hoods**

Contact Nordfab to find your local ducting expert:
800-532-0830 | 336-821-0801

www.nordfab.com